

Saramonic

2.4 GHz Dual-Channel Wireless
Microphone
Saramonic Air

User Manual

Statement

Please read this manual carefully before using, and strictly operate and store it in accordance with the instructions. Please save the manual for future reference. If you need further assistance than the user manual, please consult your retailer for help or email us at: support@saramonic.com

Cautions

1. Non-professionals are strictly prohibited from disassembling this unit on their own.
2. Please keep it away from heat sources such as radiators or spotlights.
3. Do not remove the battery without professionals' help.
4. Please clean the unit with only a soft, dry cloth.
5. When using and storing, please keep away from dust and moisture.
6. For the best pick-up pattern, do not hold your hand against the microphone capsule cover.

General Introduction

The Saramonic Air, a 2.4 GHz wireless microphone system, is designed for high-quality audio capture. The transmitters come with the $\varnothing 9.7$ mm lavalier microphone, ensuring clear and precise sound. The receiver features a high-definition color display for easy monitoring and operation of all parameters. Its compact, portable charging case provides real-time battery level display and ensures long-lasting performance. The Saramonic Air is ideal for content creation, live streaming, vlogging, mobile journalism, and much more.

Features

- Supports an exclusive $\varnothing 9.7$ mm lav mic for rich, detailed sound
- Industry-leading 90 dB SNR ensures studio-quality clarity
- 1.05" color display enable real-time monitoring
- Limiter & safety track prevent clipping
- 2-level noise cancellation & 3 EQ modes for custom sound
- One kit for all setups, hot shoe compatible

In the Box

Saramonic Air-01

Transmitter × 2

Receiver × 1

Charging Case × 1

3.5 mm TRS to TRS Cable × 1

USB-C to USB-A Data Cable × 1

USB-C Adapter × 1

Fur Windshield × 2

Magnet × 2

Receiver Belt Clip × 1

Carrying Bag × 1

Silicone Plug × 1

Saramonic Air-02

Transmitter × 2

Receiver × 1

Charging Case × 1

3.5 mm TRS to TRS Cable × 1

USB-C to USB-A Data Cable × 1

USB-C Adapter × 1

Fur Windshield × 2

Magnet × 2

Receiver Belt Clip × 1

Lavalier Microphone (1.2 M) × 2

Carrying Bag × 1

Silicone Plug × 1

Product Structure

Transmitter (Saramonic Air-TX)

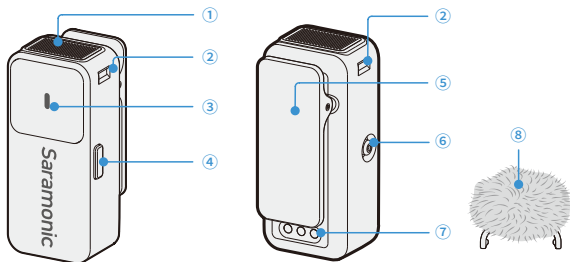

① Built-in Microphone

② Fur Windshield Hole

Install the included fur windshield here to reduce wind noise and improve audio quality.

③ Status Indicator

Status	Indicator
Unpaired	Blinks blue slowly
Pairing	Blinks blue quickly
Successfully paired	Solid blue
Mute on	Blinks red slowly
Noise cancellation enabled	Solid green
Start recording	Blinks blue twice quickly
Low battery	Blinks red
Charging (in shutdown mode)	Solid red
Fully charged	Solid blue

- When the transmitter is not paired with the receiver, the indicator on the transmitter(s) will blink blue slowly for 10 minutes. If they are not paired successfully within 10 minutes, the transmitter will automatically power off.
- Please charge the transmitter when its status indicator blinks red quickly, or it will automatically shut down after 5 minutes.

④ Power Button

- Press and hold for 2 seconds to power on or off.
- Press and hold for 5 seconds to enter pairing status in shutdown mode.
- Press once to mute or unmute the microphone.
- Press twice to start or stop recording a video when the receiver is connected to a smartphone and paired with the transmitter. Note that this feature is only supported on smartphones where the volume button functions as a camera shutter.
- Press and hold the power button for 17 seconds to force a restart of the transmitter when it is powered on.

⑤ Magnetic Clip

The transmitter can be securely attached to clothing using either the magnetic clip or the magnet for easy placement.

⑥ Mic Input Port

Designed to connect our proprietary lavalier microphone for capturing high-quality audio.

⑦ Charging Contacts

Charging will begin when the charging contacts of the transmitter connect to the charging pins of the charging case.

⑧ Fur Windshield

Receiver (Saramonic Air-RX)

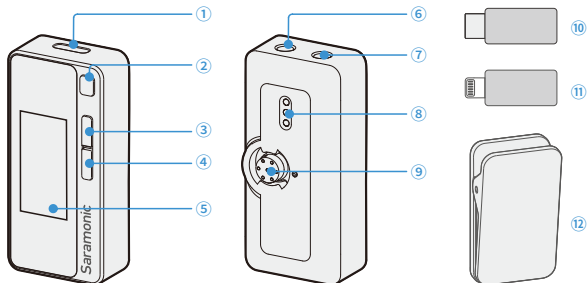

① USB-C Charging Port

When the receiver is connected to a mobile device, this port can connect to a charging cable to charge both the mobile device and receiver.

② Power Button

- Press and hold for 2 seconds to power on or off.
- When the display screen is on the home screen, press the power button once to switch between the volume adjustment options for transmitter1 (TX1), transmitter 2 (TX2), or the receiver.
- When the display screen is on the menu page, press the power button once to return to the home screen.
- Press and hold the power button for 17 seconds to force a restart of the receiver when it is powered on.

③ Menu Button

- When the display screen is on the home screen, and the volume adjustment option for transmitter 1 (TX1), transmitter 2 (TX2), or the receiver (RX) has been selected by pressing the power button, press the menu button once to increase the volume of the corresponding device.
- When the display screen is on the home screen, press and hold the menu button for 2 seconds to immediately mute the microphone on transmitter2 (TX2).
- When the display screen is on the home screen, press the menu button once to enter menu options setting.
- When the display screen is on the menu page, press the menu button to move down through the menu options, and press and hold for 2 seconds to select a menu option.

④ Noise Cancellation Button

- When the display screen is on the home screen, press the noise cancellation button once to cycle through the noise cancellation modes: strong, weak, and off.
- When the display screen is on the home screen, and the volume adjustment option for transmitter 1 (TX1), transmitter 2 (TX2), or the receiver (RX) has been selected by pressing the power button, press the noise cancellation button once to decrease the volume of the corresponding device.
- When the display screen is on the home screen, press and hold the noise cancellation button for 2 seconds to immediately mute transmitter 1 (TX1).
- When the display screen is on the menu page, press the noise cancellation button once to move up through the menu options.

⑤ Display Screen

Displays real-time recording volume, mute, battery status, noise cancellation information, input volume, output volume, and other related information for transmitter 1 (TX1), transmitter 2 (TX2), and the receiver (RX).

⑥ 3.5 mm TRS Audio Output

Used to output audio to a camera or other mobile devices.

⑦ 3.5 mm Monitor Port

Connect a 3.5 mm TRS headphone to monitor the transmitters' audio in real time. When the speaker is turned off, this port can also be used to monitor playback audio from mobile devices.

NOTE: When recording with iOS devices (e.g., iPhone or iPad), adjusting the device's volume will also change the monitoring volume on the receiver.

⑧ Charging Contacts

Charging will begin when the charging contacts of the receiver connect to the charging pins of the charging case.

⑨ Connecting Contacts

- Connect the receiver to a smartphone, tablet, computer, or other device using the provided USB-C adapter or Lightning adapter (sold separately).
- Attach the included receiver belt clip to mount the receiver onto a cold shoe.
- With the camera adapter (sold separately), the receiver can be connected to the camera's hot shoe.

⑩ USB-C Adapter

It can be connected to a smartphone, tablet, computer, or other mobile device featuring a USB-C port.

⑪ Lightning Adapter (Sold Separately)

It can be connected to a smartphone, tablet, or other mobile device featuring a Lightning port.

⑫ Receiver Belt Clip

It can be connected to the receiver's connecting points to mount the receiver on to the camera's cold shoe.

Charging Case (Saramonic Air-CC)

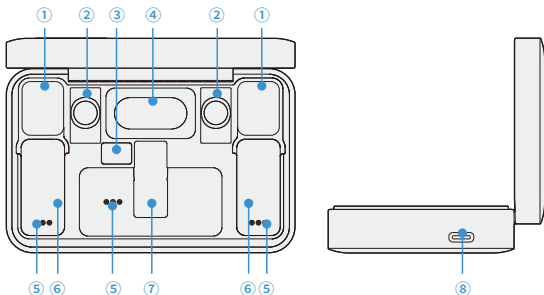

① Slot for Fur Windshields

② Slot for Adapters

③ Battery Level Indicator

- When the charging case is not connected to power, and the transmitters and receiver are placed into it for charging, the battery level indicator will display the remaining battery percentage of the charging case in real-time.
- When charging the case using the USB-C to USB-A data cable, the battery level indicator will show a green lightning icon, indicating that charging is in progress.

NOTE: When the charging case is at low or below 10%, it can not charge the transmitter(s) or receiver.

④ Slot for Receiver Belt Clip

⑤ Charging Pins

⑥ Slot for Transmitters

⑦ Slot for Receiver

NOTE: To save power, the indicators and display screen of the transmitter and receiver will automatically turn off within 1 minute after being placed in the charging case.

⑧ USB-C Charging Port

For charging the charging case via the USB-C to USB-A data cable.

Operation Guide

Pairing Transmitters and Receiver

1. The transmitter(s) and receiver will power on automatically as soon as they are taken out of the charging case.
2. The transmitter(s) and receiver are pre-paired before leaving the factory. Therefore, they will automatically pair once powered on. The indicator on the transmitter will glow solid blue when the pairing is successful.

If they are disconnected, please follow the below steps:

- ① Press and hold the power button on the transmitter(s) for 5 seconds in shutdown mode until its indicator blinks blue quickly to enter pairing mode.
- ② Press and hold the power button on the receiver for 2 seconds to turn it on. Then, select the pairing menu on the receiver's display screen and click on "Pairing".
- ③ The transmitter(s) and receiver are successfully paired when the indicator on the transmitter glows solid blue.

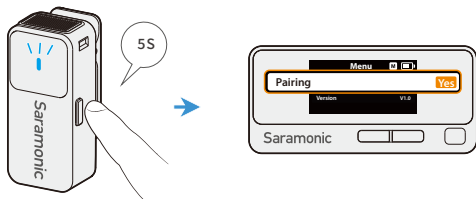

Placing Transmitter

1. Attach the fur windshield(s) to the transmitter(s) when using it outdoors or in a windy environment.



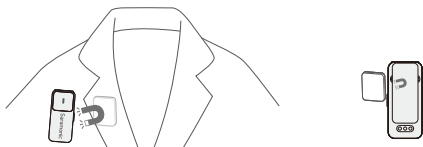

2. If using the lavalier microphone, please connect it to the MIC input port on the transmitter. To prevent the microphone from accidentally disconnecting, it is recommended to wrap the cable around the transmitter's magnetic clip before wearing it.

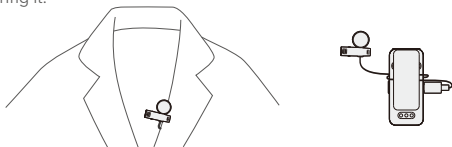

3. The transmitter can be directly attached to clothing via its magnetic clip, or using with the magnet, offering users greater flexibility when wearing the transmitter.

Using with a Mobile Device

- Mount the correct adapter on the receiver according to your device's port, and then connect the receiver to your smartphone, tablet, computer, or other mobile device. Launch the recorder or camera on the connected mobile device to start recording. The audio captured by the transmitter will be transferred to the mobile device.

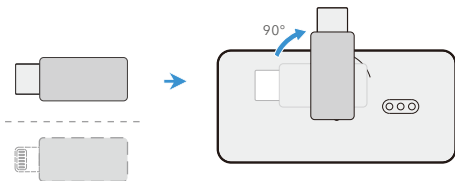

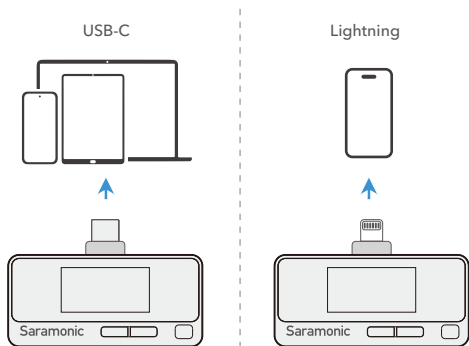

- Launch the Saramonic app or another recording app to start recording. If the app is compatible, please select the external microphone (Saramonic Air).
- In a noisy environment, it is recommended to press the NC button on the receiver once or twice to switch between strong noise cancellation and weak noise cancellation to enhance recording quality.

Recommended Scenarios for Using Noise Cancellation Mode:

Strong Noise Cancellation: Ideal for blocking out highly noisy environments such as street markets, stadiums, subway or train stations, and construction sites.

Weak Noise Cancellation: Suitable for reducing mild disturbances like air conditioners, fans, water flow, or printer operation noise.

NOTE:

When connecting the receiver to devices such as smartphones or tablets, it is recommended to use the Saramonic app for audio recording. This app provides the parameter configurations for the transmitter(s) and receiver, as well as firmware upgrades.

Using with a Camera

The receiver can be connected to the camera in the following two ways. Once connected, the audio captured by the transmitter will be transmitted to the connected device.

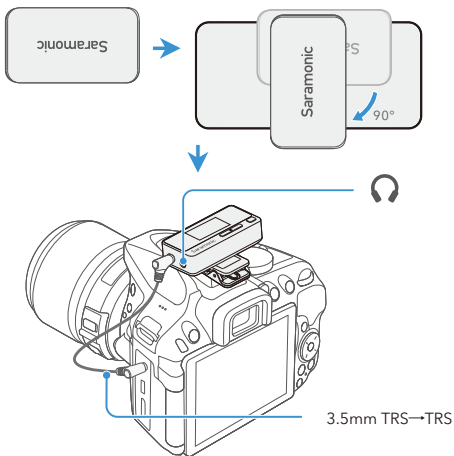

Method 1:

Mount the receiver belt clip on to the connecting contacts of the receiver. Use the included 3.5 mm TRS to TRS cable to connect the receiver's 3.5 mm audio output to a camera, mixer, and other device.

Method 2:

Mount the receiver on to the (SR-CA) Saramonic Camera Adapter via the connecting contacts, then secure the adapter to the camera's hot shoe.

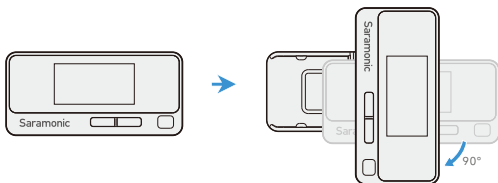

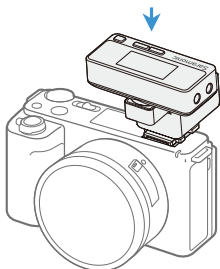

Connecting to the Saramonic app

When the receiver is connected to a mobile device such as a smartphone, tablet, or computer, the user can record audio or video, and upgrade or control both the transmitters and receiver via the Saramonic app.

Through the app, users can adjust relevant parameters of the transmitter and receiver, as well as perform firmware upgrades.

NOTE: Before recording, please upgrade the device firmware to the latest version via the Saramonic app to ensure optimal performance.

1. Scan the QR code below to download and install the Saramonic app.



2. Tap the icon  in the upper left corner, then tap "Saramonic Air Device Management" to access the control page for the receiver (RX), transmitter 1 (TX1), and transmitter 2 (TX2).

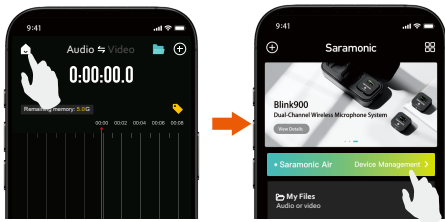

Control RX:



Swipe up on the screen to access TX1 and TX2 control:



3. Tap "Saramonic Air Detail" to view the device name, firmware version, and serial number. You can also perform "Reset to Default" or upgrade the firmware from this page. If a red dot appears next to "Device Upgrade," please prioritize completing the upgrade.

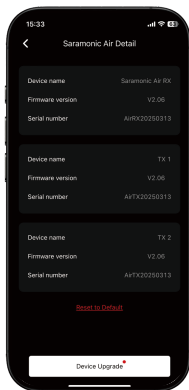

Receiver Display Screen Settings

The receiver's display screen shows the status of both the transmitter and receiver. The screen view may differ slightly from the illustrations in this User Manual due to the ongoing product updates. Please refer to the actual device.

Home Screen Overview

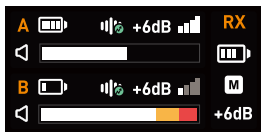
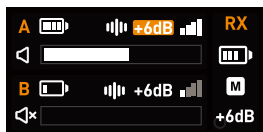

The A/B section on the home screen displays the status of transmitter 1 (TX1) / transmitter 2 (TX2).

	Indicates battery levels of the transmitter1 (TX1) / transmitter2 (TX2).
	Indicates that transmitter1 (TX1) / transmitter2 (TX2) has enabled the weak noise cancellation level.
	Indicates that transmitter1 (TX1) / transmitter2 (TX2) has enabled the strong noise cancellation level.
	Indicates the input volume levels of microphone.
	Indicates the current wireless signal strength between the transmitter 1 (TX1) / transmitter2 (TX2) and the receiver.
	Displays the real-time input volume of microphone. When appears, it indicates that the microphone is muted.

The right side of the home screen displays the device information of the receiver (RX).

	Indicates battery levels of the receiver (RX).
	Indicates the output modes of the receiver. The icons from left to right represent mono, stereo, and safety track respectively. Please refer to the "Menu Options Description" for more details.
	Indicates the output volume levels of receiver (RX).

Quick Settings: When the display screen is on the home screen, press and hold the noise cancellation button for 2 seconds to mute Transmitter1 (TX1). Press and hold the menu button for 2 seconds to mute Transmitter2 (TX2). Press the power button once to cycle through the input volume adjustment options for Transmitter 1 (TX1), Transmitter 2 (TX2), or the receiver's output volume. After selecting the volume adjustment option, press the menu button once to increase the volume, while pressing the noise cancellation button once to decrease it.

Menu Option Navigation Buttons

When the display screen is on the home screen, use the following buttons to navigate through the receiver's menu:

Menu Button:

- When the display screen is on the home screen, press the menu button once to enter the menu option setting page.
- When the display screen is on the menu option setting page, press the menu button once to move down through the menu options. Press and hold this button for 2 seconds to confirm the setting.

Noise Cancellation Button:

When the display screen is on the menu option setting page. Press the noise cancellation button once to move up through the menu options.

Power Button:

When the display screen is on the menu option setting page, press the power button once to go back to the previous option..

Menu Option Description

Menu Options	Sub Menu	Description
Output Modes	Mono	Signals from the left and right channels are mixed.
	Stereo	The left and right channel outputs correspond to the two sound sources of transmitter 1 and transmitter 2 respectively.
	Safety	The mixed output volume of the right channel is 6 dB lower than that of the left channel to prevent audio level overload in your recordings.

Speaker	On	When the receiver is connected to a smartphone, tablet, or other devices, there is no need to unplug the adapter to play audio through the device's speaker. This feature is enabled by default.
	Off	When the receiver is connected to a smartphone, tablet, or other devices, audio playback through the device's speaker is not available. NOTE: Each time the speaker is turned on or off, the receiver will automatically restart.
Limiter	On	Automatically limits the maximum audio signal volume to prevent distortion or overload, ensuring stable output.
	Off	Does not limit the audio signal. NOTE: Each time the limiter is turned on or off, the receiver will automatically restart.
Low Cut	150 Hz	Filters out low-frequency noise below 150 Hz, such as air conditioning hum or traffic noise. Suitable for environments with noticeable background noise, ensuring cleaner and purer audio capture.
	75 Hz	Filters out low-frequency noise below 75 Hz, such as wind noise, device operation noise. Suitable for outdoor environments to enhance audio clarity and reduce low-frequency interference.
Brightness	-	Click to enter the "Brightness" menu to adjust the receiver display brightness to 25%, 50%, 75%, or 100%.
Backlight	-	Click to enter the "Backlight" menu to select the desired display timeout setting, with options between 10 minutes and always on.
TX Indicator	-	Once the transmitter and receiver are successfully paired, you can adjust the brightness of the transmitter's status indicator to 25%, 50%, 75%, 100%, or turn it off. If the transmitter and receiver are not paired, the indicator will display the working status normally and will not be affected by this setting.

Language	-	Click to enter the "Language" menu to set the display language of the receiver to English, 简体中文(Simplified Chinese), or Русский язык (Russian) .
Pairing	-	Click to enter the "Pairing" menu to connect the transmitter and receiver. If the connection is successful, the transmitter's status indicator will glow solid blue.
Reset to Default	-	Click to enter the "Reset to Default" menu. After resetting, the receiver's parameters will be restored to the default values.
Version	-	Click to enter the "Version" menu, and the display screen on the receiver will show the firmware version information of both the transmitter and receiver.

Storing

The charging case can store two transmitters, two magnets, two fur windshields, an adapter, a receiver, and a receiver belt clip. After recording, please place the units back into the charging case as shown in the diagram.

NOTE:

After placing the adapters and belt clip into their designated slots, gently press them to secure and prevent movement.

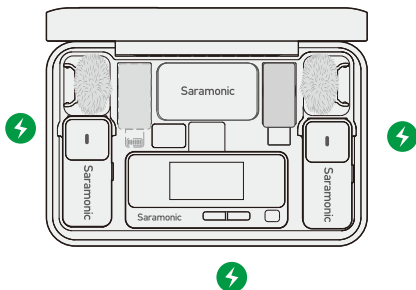

Troubleshooting

If you encounter problems when using the unit, please refer to the following checklist first. If the problem cannot be solved, please contact the dealer's after-sales service department.

- **The transmitter(s) can not pair with the receiver**

Turn off the transmitter(s) and the receiver. Press and hold the power button on the transmitter for more than 5 seconds until the indicator blinks blue quickly. Then select "pairing" on the menu page of the receiver to pair again.

- **Operating range is limited, sound changes, or noise appears**

- ① Make sure there is no interference from high-power wireless routers or devices in your recording environment. If the recording environment can't be changed, you need to find the optimal distance and angle for recording.
- ② Due to 2.4 GHz wireless frequency, signal can be easily attenuated. Please try to avoid obstacles, such as walls and buildings, and avoid close proximity to devices with 2.4 GHz signal, such as high-power Wi-Fi antennas, radios, etc.
- ③ Make sure the receiver is well connected to your device properly.

- **The transmitter(s) or the receiver doesn't power on**

If the battery is completely depleted due to the transmitter(s) or the receiver has not been used for a long time, charge it.

- **Charging case can't charge the transmitter(s) or receiver**

- ① If the remaining charge of the charging case is too low, please recharge the case and try again.
- ② Wipe the charging contacts on the transmitter(s), receiver, and charging pins in the case with a clean cloth. Make sure there is no dirt covering them.
- ③ If the charging contacts and pins are not firmly connected due to insufficient magnetic force, please contact Saramonic after-sales support.

- **Howling noise occurs when using the receiver with an adapter**

Make sure your phone's speaker is off in the receiver's touchscreen.

- **No audio playback from the receiver's monitor output**

Please ensure that the transmitter and receiver are successfully paired, and that the receiver's speaker is turned off.

- **Receiver powers off automatically when the audio cable is removed from a camera, sound card, or other device**

Check if the "RX powers on or off with camera" is enabled on the receiver. When this function is enabled, the receiver will automatically power off if it detects that the connected device (e.g., camera or sound card) is disconnected.

You can disable this function in the Saramonic App. Once disabled, the receiver will no longer automatically turn off due to disconnection from connected devices.

Specifications

Transmitter (Saramonic Air TX)

Transmission Type	2.4 GHz digital frequency
Transmission Range	Up to 300 m (without obstacles)
Modulation	GFSK
Polar Pattern	Omnidirectional
Antenna	PIFA
RF Output Power	< 10 dBm
Distortion	≤ 0.02 %
Frequency Response	20 Hz to 20 kHz
Sensitivity	-32 dB
Reference Audio Input Level	1.5 V
Sampling Rate	48 kHz
Bit Rate	24-bit
Signal-to-noise Ratio	90 dB
Max SPL	120 dB
Audio Input	6 mm omnidirectional condenser microphone capsule
Power Supply	Built-in lithium-ion battery
Battery Capacity	85 mAh
Battery Life	10 hours
Charging Time	Approx. 1.5 hours (5 V / 1 A)
Weight	11 g
Dimensions	36 × 16 × 13.2 mm (L × W × H)
Operating Temperature	-10°C to 50°C
Storage Temperature	-10°C to 50°C

Receiver (Saramonic Air-RX)

Transmission Type	2.4 GHz digital frequency
Transmission Range	Up to 300 m (without obstacles)
Modulation	GFSK
Polar Pattern	Omnidirectional
Antenna	FPC antenna and monopole antenna
RF Output Power	< 10 dBm
Distortion	≤ 0.02 %
Frequency Response	20 Hz to 20 kHz
Signal-to-noise Ratio	90 dB
Audio Output	Lightning / USB-C / 3.5 mm TRS output; 3.5 mm monitor port
Power Supply	Built-in lithium-ion battery
Battery Capacity	225 mAh
Battery Life	Screen On: 6.5 hours; Screen Off: 9.5 hours
Charging Time	Approx. 1.5 hours (5 V / 1 A)
Weight	22 g
Dimensions	53 × 25 × 15.5 mm (L × W × H)
Operating Temperature	-10°C to 50°C
Storage Temperature	-10°C to 50°C

Charging Case (Saramonic Air-CC)

Battery Type	Built-in Li-ion battery
Battery Capacity	1300 mAh
Power Supply	USB-C port
Charging Time	Approx. 2.5 hours (5 V / 2 A)
Charging Cycles	Approx. 1.5 times (2*TX+1*RX)
Weight	147 g
Dimensions	109.4 × 69.9 × 27.5 mm (L × W × H)
Operating Temperature	-10°C to 50°C
Storage Temperature	-10°C to 50°C



For better recording experience, the application



Scan the QR code to access the tutorial videos



Scan the QR code and follow us!

Shenzhen Jiayz Photo Industrial., Ltd

A16 Building, Intelligent Terminal Industrial Park of Silicon Valley
Power, Guanlan, Longhua District, Shenzhen, China

☎ 400-613-1096 🌐 www.saramonic.com ✉ support@saramonic.com