

Saramonic

2.4GHz Four-Channel
Wireless Microphone System

2.4GHz四通道无线麦克风系统

Blink500T4

User Manual
用户手册

Statement

Please read this manual carefully before using and strictly operate and store it in accordance with the instructions. Please save the manual for your future reference. If you need further assistance than the user manual, please consult your retailer for help or email us: info@saramonic.com

Cautions

1. Disintegration of this device by non-professionals is strictly prohibited.
2. Please keep it away from heat sources such as heaters or ovens.
3. Do not remove the battery without professionals' help.
4. Please clean the device with only a soft, dry cloth.
5. When using and storing, please keep away from the dust and moisture.
6. For the best pick-up pattern, do not hold your hand against the microphone capsule cover.

Introduction

The Saramonic Blink500T4, a four-channel wireless microphone system, has four sound sources miked up simultaneously with ease. The audio of four tracks is able to be separately output by the receiver at the same time, which is enough for audio post-production. Also, the receiver supports Mono and Stereo output.

The transmitter features high-performance noise cancellation, which is available for improving the recording effect in a noisy environment. You can choose to use the transmitter with the 3.5mm external lavalier microphone or its built-in omnidirectional microphone as your needs.

This kit can record multiple sound sources for 4-person performances, conferences, speeches, podcasts, vlogging, mobile journalism, and more. It is compatible with cameras, recorders, mixers, smartphones, tablets, laptops, etc.

* The Blink500T4 operates on the 2.4GHz spectrum and automatically hops to free channels to avoid static noise and audio dropouts.

Features

- Up to 100 meters of wireless transmission
- High-performance noise cancellation algorithms - 48kHz HD audio format retained
- Wide-range 20-20,000Hz frequency response - deliver exceptional high-quality sound
- Up to 11 hours of operating time for a transmitter
- Mixed or Separate four-channel audio output setting
- Receiver's 3.5mm headphone output - monitor your audio in real-time

Product Structure

Blink500T4 TX Wireless Transmitter

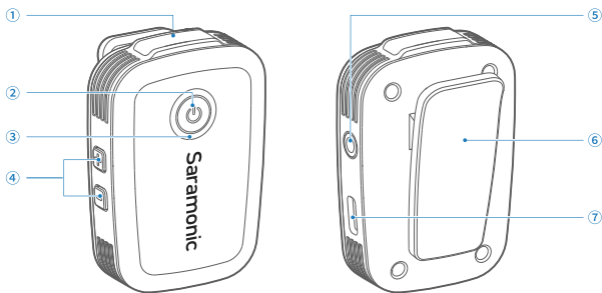

① Built-in Microphone

② Power Button

Function	Operation
Power ON/OFF	Press and hold for 2 seconds
Mute ON/OFF	Press
Pair	Press and hold for 5 seconds in the shutdown mode

③ Status Indicator

Status	Indicator
Power ON	Blue light on for 1 second
Unpaired	Blinks blue rapidly (per second)
Pairing	Blinks blue 3 times rapidly
Pairing Successfully	Static blue light
Mute ON	Blinks red rapidly (every half second)
Noise Cancellation ON	Static green light
Noise Cancellation OFF	Green light off
Maximum / Minimum Gain	Blinks blue twice rapidly
Low Battery	Blinks red slowly (every 2 seconds)
Charging	Static red light
Fully Charged	Static blue light

Note: Please charge the transmitter in time when in a low battery status, or it will auto shut off within 10 mins.

④ +/- / NC Button

- Press +/- button to adjust mic gain (totally 7 levels). The setting is retained even after the power is turned off.

Note: By default, the mic gain is at the second level after a reboot if the transmitter's gain is set at a minimum before shutting down.

- Press and hold or continuously press "+" / "-" to adjust mic gain to maximum/minimum level, the indicator blinks blue twice rapidly.
- Press the NC button (press both "+" and "-" buttons at the same time) to turn on/off noise cancellation. Default setting is off.

⑤ Mic in Jack

It can be connected to a 3.5mm TRS microphone, such as the included lavalier microphone.

⑥ Belt Clip

⑦ USB-C Charging Port (DC 5V)

Use the supplied USB-C charging cable to charge the unit.

Blink500T4 RX Wireless Receiver

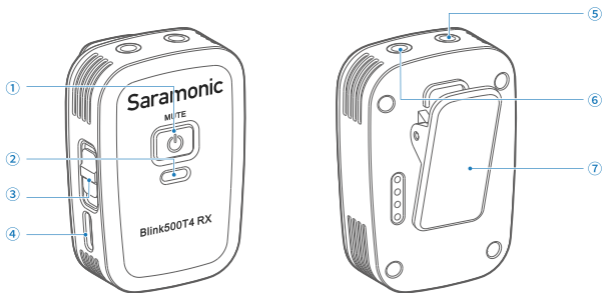

① Power Button

Function	Operation
Power ON/OFF	Press and hold for 2 seconds
Mute ON/OFF	Press
Pair	Press and hold for 5 seconds in the shutdown mode

② Status Indicator

Status	Indicator
Power ON	Blue light on for 1 second
Unpaired	Blinks blue rapidly (per second)
Pairing	Blinks blue 3 times rapidly
Pairing Successfully	Static blue (4 channels off)
	Static green (4 channels on)
Mute ON	Blinks red rapidly (every half second)
Low Battery	Blinks red slowly (every 2 seconds)
Charging	Static red light
Fully Charged	Static blue light

Note: Please charge the receiver in time when in a low battery status, or it will auto shut off within 10 mins.

③ Output Mode Toggle

Slide up or down to switch the mode between mixed audio output and independent audio output for four channels.

④ USB-C Charging Port (DC 5V)

Use the supplied USB-C charging cable to charge the unit.

⑤ 3.5mm Headphones Output

Connect headphones for audio monitoring.

⑥ LINE OUT Jack

Connect the RX to a DLSR camera, smartphone, computer, mixer or amplifier with the appropriate output cable.

⑦ Belt Clip

Operation Guide

1. Press and hold the power buttons for 2 seconds to turn on the receiver and the transmitter(s).

2. Pairing

The transmitter(s) and receiver are paired by default. If they are disconnected, please follow the below steps:

- ① Press and hold the power button of transmitter(s) and receiver for 5 seconds in shutdown mode to make them enter the pairing state. Their status indicators would blink blue 3 times rapidly.
- ② Transmitter(s) and receiver will be successfully paired within 10 seconds. Their status indicators would turn static blue.

3. The receiver can be paired with up to four transmitters. If the four-channel output was off, the audio would be output in mono. If the four-channel output was on, the audio of four channels would be output independently via a 4-in-1 audio cable. Or the audio would be output in stereo via a 3.5mm TRRRS to 3.5mm TRS/ TRRS audio cable, where signals from transmitters 1 and 3 would be recorded to the left channel, and signals from transmitters 2 and 4 would be recorded to the right channel. (The numbers are the transmitter's pairing order.)

4. You are ready to record.

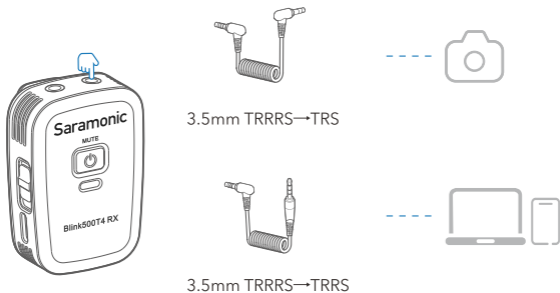

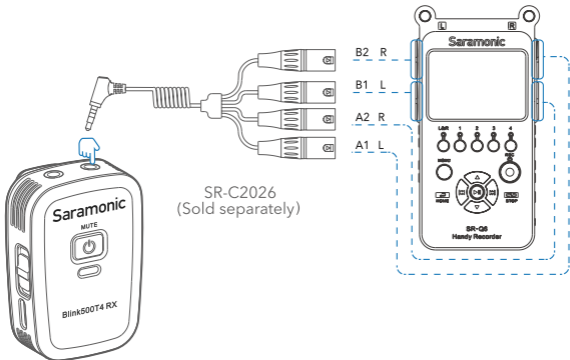

SR-C2026
(Sold separately)

NOTE:

- In order to avoid channel preemption during multi-channel recording, please set up the receiver first, and then pair the transmitters with it in turn.
- If a certain transmitter of Blink500T4 failed to pair, please turn off the paired transmitter, and then reconnect the unpaired transmitter and receiver.
- Due to the 2.4GHz wireless frequency is widely used, the signal may be easily attenuated or interfered. Please try to avoid obstacles while using, such as walls and buildings. And keep away from the devices with 2.4GHz frequency, such as high-power Wi-Fi antennas, radios, etc.
- Whether the four-channel output mode is on or off, the monitoring jack outputs audio in mono.

Troubleshooting

If you encounter problems when using the unit, please refer to the following checklist before contacting technical support. If the problem cannot be solved, please contact the dealer's after-sales service department.

- **If there is no sound from the unit or no sound when connected to an external device**
 - ① Make sure the receiver is well connected to your device properly.
 - ② Make sure the audio cable used is right.
 - ③ Make sure the gain and volume are not turned to a minimum.
 - ④ Make sure the transmitter(s) is not muted.

- **If sound of the unit is too low or too loud or even distorted**
 - ① Adjust the mic gain and find the most suitable level for recording in the current situation to improve the recording effect.
 - ② If you are recording in noisy environment, it is recommended to enable noise cancellation to improve the recording effect.

- **Current noise or other abnormal noise appears during monitoring**

Make sure there is no interference near the unit. If the noise still exists after changing the unit's position, please contact our customer service.

- **The operating range of the unit is limited and the sound is frequently intermittent**

Make sure there is no interference between the transmitter(s) and receiver. If the intermittent sound still occurs frequently, please contact our customer service.

In the Box

- 4× Blink500T4 TX Transmitter
- 1× Blink500T4 RX Receiver
- 4× SR-M1 Omnidirectional Lavalier Microphone (with Foam Windscreen and Mic Clip)
- 1× 3.5 mm TRRRS to 3.5 mm TRS Output Cable for Camera
- 1× 3.5 mm TRRRS to 3.5 mm TRRS Output Cable for Smartphone
- 1× 3.5 mm TRRRS Male to Four 3.5 mm TRS Male Output Cable
- 2× USB-A to Triple Head USB-C Charging Cable
- 1× Carrying Case

Other Adapter Cables (sold separately)

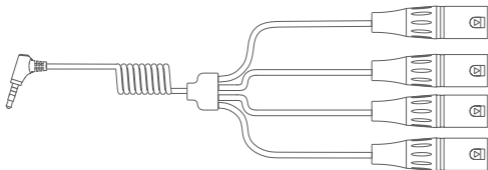

3.5 mm TRRRS Male to Four XLR Female Audio Cable (SR-C2026)

Specifications

Blink500T4 TX Transmitter

Transmission Type	2.4GHz Digital Frequency
Modulation	GFSK
Polar Pattern	Omnidirectional
Antenna	Built-in Antenna
Operating Range	Up to 100m (Measured in open environment without obstacles and interference.)
RF Output Power	<10mW
Frequency Response	20Hz-20kHz
Sampling Rate/ Bit Depth	48kHz/ 24bit
Maximum SPL	Built-in microphone: 120dB SPL
Sensitivity	Built-in microphone: -39 ± 2 dB (0dB=1V/Pa@1kHz)
Signal-to-Noise Ratio	> 80dB
Audio Input	Built-in Microphone or 3.5mm Mic Input Jack
Charging Port	USB-C Port (DC 5V)
Battery Voltage / Capacity	3.7V/ 300mAh
Battery Life	Approx. 12 hours (This value is tested in a laboratory environment when recording and should be used for reference only)
Charging Time	Approx. 2.5 hours
Weight	34g
Dimensions	60.8mm×42.5mm×16.2mm
Operating Temperature	0°C to 50°C
Storage Temperature	-20°C to 50°C

Blink500T4 RX Receiver

Transmission Type	2.4GHz Digital Frequency
Modulation	GFSK
Antenna	Built-in Antenna
Operating Range	Up to 100m (Measured in open environment without obstacles and interference.)
RF Output Power	<10mW
Frequency Response	20Hz-20kHz
Sampling Rate/ Bit Depth	48kHz/ 24bit
Signal-to-Noise Ratio	> 80dB
Audio Output Mode	Separate four-channel audio output or mixed audio output
Audio Output Connector	3.5mm TRRRS LINE OUT Jack
Monitor Connector	3.5mm TRS Headphones Jack
Charging Port	USB-C Port (DC 5V)
Battery Voltage / Capacity	3.7V/ 400mAh
Battery Life	Approx. 8 hours (This value is tested in a laboratory environment when recording and should be used for reference only)
Charging Time	Approx. 2.5 hours
Weight	30g
Dimensions	56mm×38mm×17.4mm
Operating Temperature	0°C to 50°C
Storage Temperature	-20°C to 50°C

声明

请在使用前仔细阅读本手册，并严格按照说明进行操作和存储。请妥善保存好说明书以供将来参考。如果用户手册不能帮助您解决某些问题，请向零售商寻求帮助或给我们发送电子邮件：info@saramonic.com。

注意事项

1. 请勿擅自拆开机壳；
2. 请勿将本机靠近热源，如散热器、聚光灯或其他产生热量的设备；
3. 电池不可自行更换；
4. 请使用柔软的干布清洁本设备；
5. 在使用和储存时，请注意防尘和防潮；
6. 为获得最佳拾音效果，请勿将手放在麦克风咪头上。

概述

枫笛Blink500T4套件是一款四通道无线麦克风系统，支持对四个声音源同时进行录制。接收器支持四通道同步独立输出、单声道输出、立体声输出，提供了强大的后期音频处理空间。除了内置的全向麦克风外，发射器也可以外接3.5mm领夹麦使用；且具有高性能降噪功能，从容应对嘈杂的录音环境。

该套件能够满足需要多个声音源的活动需求，适用于多人表演、会议、演讲、播客、Vlog拍摄、街头采访等场景，兼容相机、录音笔、混音器、智能手机、平板、电脑等设备。

* Blink500T4所使用的是抗干扰2.4GHz频段，遇到干扰情况下能自动跳转频道避免噪音产生以及音频失真。

特点

- 无线传输距离达100米
- 自研高性能降噪算法, 且支持48kHz高清音频格式
- 20-20,000Hz频响范围, 高品质还原真实声音
- 发射器支持12小时单次超长续航
- 接收器支持4轨音频独立输出、单声道输出以及立体声输出
- 接收器支持接入3.5mm耳机实时监听

产品结构

Blink500T4 TX无线发射器

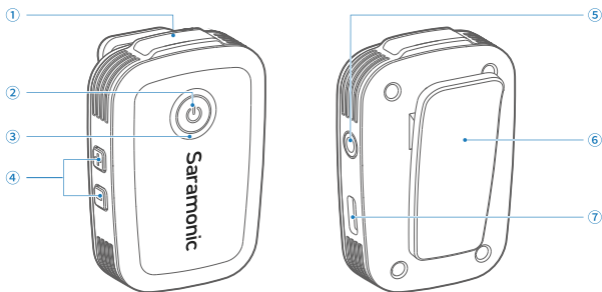

① 内置麦克风

② 电源键

功能	操作
电源开启 / 关闭	长按电源键 2 秒
静音开启 / 关闭	短按电源键
配对	关机状态下长按电源键5秒

③ 状态指示灯

模式	指示灯
开机	蓝灯亮一秒
未联机	蓝灯快闪(每秒 1 次)
对码中	蓝灯快闪三次
联机成功	蓝灯常亮
静音模式开启	红灯快闪(每 0.5 秒闪 1 次)
降噪模式开启	绿灯常亮
降噪模式关闭	绿灯熄灭
最大 / 最小增益	蓝灯快闪两次
低电量	红灯慢闪(每两秒 1 次)
充电中	红灯常亮
充满电	蓝灯常亮

注意: 发射器处于低电量时请及时充电, 否则发射器将在 10 分钟内自动关机。

④ +- / NC 键

- 短按 + 或 - 键调节麦克风增益(共7档), 该参数设定在电源关闭后仍保留;
注意: 发射器增益如在关机前处于最小档, 重启后默认为第二档。
- 长按或连续按“+”或“-”可将麦克风增益调节至最大 / 最小, 指示灯呈蓝灯快速闪烁两次;
- 短按 NC 键(+ 键同时按)开启 / 关闭降噪功能, 默认降噪功能为关闭状态。

⑤ 麦克风输入

连接 3.5mm 领夹麦或其他 3.5mm TRS 麦克风。

⑥ 背夹

⑦ Type-C 充电口 (直流电 5V)

使用随附的 Type-C 充电线为该设备充电。

Blink500T4 RX无线接收器

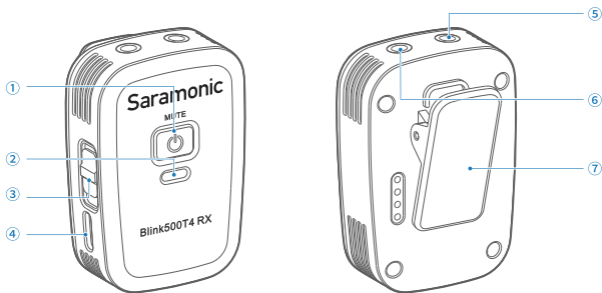

① 电源键

功能	操作
电源开启 / 关闭	长按电源键 2 秒
静音开启 / 关闭	短按电源键
配对	关机状态下长按电源键5秒

② 状态指示灯

模式	指示灯
开机	蓝灯亮一秒
未联机	蓝灯快闪 (每秒 1 次)
对码中	蓝灯快闪三次
联机成功	蓝灯常亮 (四音轨关闭)
	绿灯常亮 (四音轨开启)
静音模式开启	红灯快闪 (每 0.5 秒闪 1 次)
低电量	红灯慢闪 (每两秒 1 次)
充电中	红灯常亮
充满电	蓝灯常亮

注意: 接收器处于低电量时请及时充电, 否则发射器将在 10 分钟内自动关机。

③ **输出模式切换键**

上下拨动此键即可切换混合输出模式与四通道独立输出模式。

④ **Type-C 充电口 (直流电 5V)**

使用随附的 Type-C 充电线为该设备充电。

⑤ **3.5mm 耳机监听孔**

接入耳机进行音频监听。

⑥ **线性输出孔**

使用相应的输出线, 连接至单反相机, 手机, 电脑, 混音器等设备。

⑦ **背夹**

操作指南

1. 长按电源键2秒，将发射器和接收器开机。

2. 配对

发射器和接收器出厂前已配对成功。若其断开连接，请进行如下配对操作：

- ① 关机状态下依次长按发射器和接收器电源键5秒。使其进入配对状态，其指示灯均呈蓝灯快闪3下。
- ② 发射器和接收器将在10秒内完成配对，其指示灯均呈蓝灯常亮。

3. 接收器最多可以与4个发射器配对。当接收器四通道输出关闭时，输出音频均为单声道。当接收器四通道输出开启后，连接一分四音频线可独立输出四个通道音频；连接3.5mm TRRRS转3.5mm TRS/ TRRS音频线可输出立体声音频，其中左右声道输出分别对应发射器1、3和发射器2、4两个声源的声音。（序号为发射器的配对顺序）

4. 开始录制。

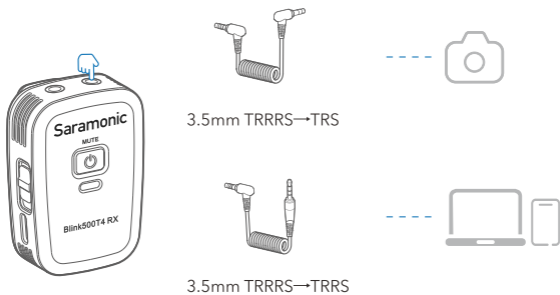

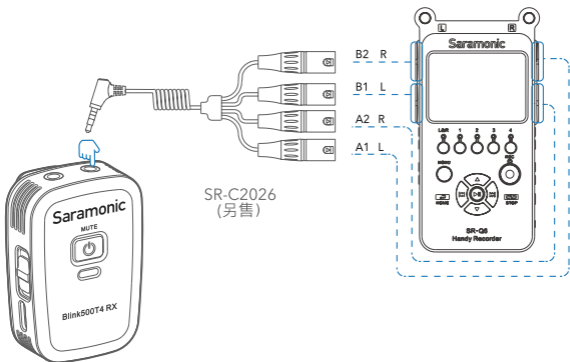

注意:

- 使用多通道录音时, 为了避免通道抢占, 请先操作接收器, 然后依次将发射器与之配对。
- 若Blink500T4在对码过程中出现某一台发射器配对不成功的情况, 则需要将已对码的发射器关机后, 再将未对码的发射器与接收器进行重新配对。
- 由于在2.4GHz频谱下, 信号很容易受干扰, 请尽量避开墙壁和建筑物等障碍物, 避免接近2.4GHz频率的设备, 如大功率Wi-Fi天线、收音机等。
- 不管四通道输出模式开启或关闭, 监听孔的音频均为单声道输出。

故障排除

在使用本机的过程中出现任何问题，请参照以下内容加以解决。如果此手册仍然无法解决您遇到的问题，请与我们当地的经销商售后服务部联系。

- **本机无声音**

- ① 检查产品是否连接正常以及转接线是否有松动。
- ② 检查所使用的转接线是否正确。
- ③ 检查增益、音量是否被调至最低。
- ④ 检查发射器、接收器是否开启了静音模式。

- **本机声音过小或过大甚至破音**

- ① 通过调节增益，找到最适合当前环境录制的档位，提高录制效果。
- ② 若录音环境较为嘈杂，可开启发射器的降噪模式，提高录制效果。

- **监听时有不干净的电流声或异常噪音等**

请检查本机附近是否有干扰源；若本机更换使用位置后还是有噪音，请联系客服咨询。

- **产品的使用距离受限且声音频繁断续**

查看发射器、接收器之间是否有干扰源，将产品更换使用位置再次确认，若声音还是频繁断续，请联系客服咨询。

包装清单

- 4× Blink500T4 TX发射器
- 1× Blink500T4 RX接收器
- 4× SR-M1全向型领夹麦 (带防风海绵和麦夹)
- 1× 3.5mm TRRRS转3.5mm TRS相机音频线
- 1× 3.5mm TRRRS转3.5mm TRRS手机音频线
- 1× 3.5mm TRRRS转四头3.5mm TRS音频线
- 2× USB-A转三头Type-C充电线
- 1× 收纳盒

其他音频转接线 (单独出售)

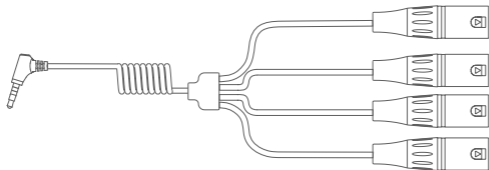

3.5mm TRRRS转四头XLR音频线 (SR-C2026)

参数

Blink500T4 TX发射器

传输方式	2.4GHz数字频段
信号调制	高斯频移键控
极性模式	全向型
天线	内置天线
操作范围	最远至100米(在无障碍无干扰空旷环境测得)
射频输出功率	< 10mW
频率响应	20Hz-20kHz
采样率/位深	48kHz/ 24bit
最大声压级	内置麦克风: 120dB SPL
灵敏度	内置麦克风: $-39\pm 2\text{dB}$ ($0\text{dB}=1\text{V}/\text{Pa}@1\text{kHz}$)
信噪比	> 80dB
音频输入	内置麦克风或3.5mm外接麦克风输入
充电接口	Type-C充电口(直流电 5V)
内置锂电池规格	3.7V/ 300mAh
续航时长	约12小时(在实验环境下连续录音测得, 数值仅供参考)
充电时长	约2.5小时
重量	34g
尺寸	60.8mm×42.5mm×16.2mm
工作温度	0°C to 50°C
贮存温度	- 20°C to 50°C

Blink500T4 RX接收器

传输方式	2.4GHz数字频段
信号调制	高斯频移键控
天线	内置天线
操作范围	最远至100米(在无障碍无干扰空旷环境测得)
射频输出功率	< 10mW
频率响应	20Hz-20kHz
采样率/位深	48kHz/ 24bit
信噪比	> 80dB
音频输出模式	四通道独立输出/混合输出
音频输出接口	3.5 mm TRRS线性输出孔
监听接口	3.5mm TRS耳机监听孔
充电接口	Type-C充电口(直流电 5V)
内置锂电池规格	3.7V/ 400mAh
续航时长	约8小时(在实验环境下连续录音测得, 数值仅供参考)
充电时长	约2.5小时
重量	30g
尺寸	56mm×38mm×17.4mm
工作温度	0°C to 50°C
贮存温度	- 20°C to 50°C



For better recording experience, the application Saramonic is recommended.

为获得更好的录制体验, 推荐使用枫笛 Saramonic 自主研发应用软件 Saramonic。



Scan the QR code and follow us!
扫描微信二维码关注枫笛公众号!

Shenzhen Jiayz Photo Industrial., Ltd
深圳市长丰影像器材有限公司

A16 Building, Intelligent Terminal Industrial Park of Silicon Valley
Power, Guanlan, Longhua District, Shenzhen, China
深圳市龙华区观澜街道大富工业区硅谷动力智能终端产业园A16栋